

# *Video Baby Monitor*

*By Babysense™*



## **User Manual**

**Wireless Digital Video Baby Monitor**

*Watch, Listen and Talk to Your Baby*

**Model: V35TX, V35RX (Video Baby Monitor with one camera)**

*For any product related question please contact us at [service@hisense.co.il](mailto:service@hisense.co.il)*

*or Toll Free Number (833) 568-2229*

[www.babysensellc.com](http://www.babysensellc.com)

## Table of Contents

<b>1 Warnings and Safety Instructions</b> .....	3
1.1 WARNINGS: .....	3
1.2 Safety Instructions for AC Power Adapter .....	4
1.3 Safety Instructions for Li-ion battery .....	5
1.4 Information on disposal of battery and product .....	5
<b>2 Overview</b> .....	6
2.1 Pack Contents .....	6
2.2 Parent Unit Overview .....	6
2.3 Baby Unit Overview .....	7
2.4 Icons Overview .....	7
<b>3 Getting Started</b> .....	8
3.1 Powering Baby Unit (Camera) .....	8
3.2 Powering Parent Unit .....	8
3.3 Charging Parent Unit .....	8
3.4 Set Up .....	8
<b>4 Operating the Monitor</b> .....	9
4.1 Pairing the Baby Unit with Parent Unit .....	9
4.2 Switching between the paired Baby Units .....	9
4.3 Scan Mode- Automatic switching between the paired Baby Units .....	10
4.4 Deleting the Baby Unit .....	10
4.5 ECO Mode .....	10
4.6 Audio Only Mode – (Video OFF – Audio ON) .....	11
4.7 Talk To Baby .....	11
4.8 Digital Zoom & Image Pan/Tilt .....	11
4.9 Volume Adjustments .....	11
4.10 Brightness Adjustments .....	12
4.11 Temperature Setting .....	12
4.12 Lullaby & White Noise Setting .....	12
4.13 Warning Alert Setting .....	13
4.14 Night Light .....	13
<b>5 Using Wide Angle Lens</b> .....	13
<b>6 Maintenance</b> .....	14
<b>7 Troubleshooting</b> .....	14
<b>8 Specifications</b> .....	16
<b>9 FCC Statements</b> .....	16
<b>10 IC Statements</b> .....	17
<b>11 Warranty Terms</b> .....	17
<b>12 Customer Support</b> .....	17

## 1. Warnings and Safety Instructions

Follow these safety precautions to prevent fire, injury or damage to the product.

**Read and keep instructions:** It is very important that you read all the safety and operating instructions before the Babysense video monitor is operated.

Please retain your purchase receipt as you will need to produce it if warranty service is required.

### 1.1 WARNINGS:

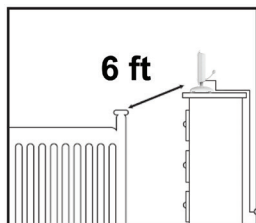

- **STRANGULATION HAZARD:** Children can become entangled in cords. Make sure the Baby unit, Parent unit and mains adaptor cables are kept out of reach of your baby and other young children at all times, at least 6 feet away.
- **CHOKING HAZARD:** This product contains small parts which may cause choking. Exercise care when unpacking and assembling the product and keep the small parts away from children.
- **RISK OF SUFFOCATION:** Keep all packaging materials and protective foils out of reach of children.
- **DANGER FROM POWER CORDS:** To avoid possible danger from power cords, the cords should be secured and never be hung on or near the crib. Never place the Baby unit or Parent unit inside your baby's crib, bed or playpen.
- **DO NOT HANDLE ROUGHLY, DROP OR THROW:** Babysense video monitor is a high quality electronic device which must be handled with care.
- This product is designed for **INDOOR USE ONLY**.
- **WATER AND MOISTURE:** The product should not be exposed to rain, moisture, or splashing. Never use or place the product in or near moisture or water.
- **THIS PRODUCT CANNOT REPLACE RESPONSIBLE ADULT SUPERVISION:** Your video monitor is designed to be an aid and should not be used as a substitute for responsible and proper adult supervision of a child.
- **POWER SOURCE:** This product should only be used with the AC power adapters supplied by the manufacturer, as included in this package.
- **VENTILATION:** This product should not be used on a bed, sofa, rug or similar surface that may block the ventilation or speaker openings, or be placed in an enclosed area, such as a bookcase or drawer that may impede air flow. Never cover the product with clothes, towels, blankets or any other item.
- **THIS PRODUCT IS NOT A TOY:** It should be kept out of children's reach.
- **KEEP AWAY FROM SOURCES OF HEAT:** This unit should not be exposed to direct heat sources. The unit should not be such as a candle, stove, radiator, heat register or other appliance that emit heat. left in direct sunlight.

- **BATTERY:** Before you use the product, we recommend you fully charge the battery of the Parent Unit, so that it continues to work if you disconnect it from the power supply to carry it to another location.
- **INSTALLATION LOCATION:** The installation location plays an important role in ensuring proper operation. Therefore, maintain a distance of at least 5 feet from other electronic equipment, such as microwave ovens or Wi-Fi routers, otherwise they could cause interference. If this occurs, move the baby and parent units to another location.
- **RANGE:** Range of all baby monitors is always measured in an open space. The actual range may be shortened due to environmental obstacles (such as concrete walls).
- **DAMAGE REQUIRING SERVICE:** This product should be serviced by qualified personnel only.
- **DO NOT TRY TO OPEN AND REPAIR THE PRODUCT:** If you have any problems with the product, please contact the authorized distributor.
- In case of unusual noises or smells originating from the device, immediately disconnect the product from the power outlet and contact authorized distributor.
- If the product becomes dirty, use a lightly damp soft cloth to wipe surfaces, taking care to not allow water into any openings.

**IMPORTANT:** Babysense Video Monitor is designed only for hearing the baby's voice and seeing the images of the baby. This product is not a medical device and should not be used as a substitute for responsible adult supervision. It is important that you regularly check on your baby personally.

## 1.2 Safety Instructions for AC Power Adapter

- The adapter should not be exposed to direct heat sources such as a candle, stove, radiator, heat register or other appliance that emit heat.
- During continual use, the power adapters may become warm to the touch. This is normal and should not be a cause of concern.
- Examine intactness of the power cord and its plug.
- The adapter must be handled with care: Do not handle roughly, drop or throw.
- When removing the power adapter from the wall outlet, hold and pull from the receptacle.
- Do not pull on the cable itself or bend the cable as that will put additional stress on the cable and could lead to damages.
- Do not touch the power adapter with wet hands or allow liquids to spill on it.
- Make sure the mains adaptor cables are kept out of reach of your baby and other young children at all times. To avoid possible danger from power cords, the cords should be secured and never be hung on or near the crib.
- Do not replace the plugs or cable on your power adapter. This product should only be used with the AC power adapters supplied by the manufacturer, as included in this package.
- Never cut, damage or bend the power cord.
- Do not put any objects on top of the power cord, which could cause overheating, damage, combustion and electrocution.
- Do not leave the power adapter connected to the wall outlet when it is not plugged into the Baby or Parent unit.

### **WARNING:**

- Do not replace the power cord with non-original substitutes. Improper connection may cause electrocution.
- Do not place the AC adaptor cable in a high wear and tear location. Never use a frayed or compromised cord.
- Intended for indoor use only.

### 1.3 Safety Instructions for Li-ion battery

- Do not attempt to repair or adjust any of the electrical or mechanical functions of the unit.
- Do not dismantle, cut, open, crush, bend, puncture, or shred cells or batteries.
- If a battery leaks, do not let the battery liquid touch skin or eyes. If this happens, immediately flush the affected areas with water, and seek medical assistance.
- The battery should not be exposed to direct sunlight or heat sources such as a candle, stove, radiator, heat register or other appliance that emit heat.
- Do not modify, remanufacture, attempt to insert foreign objects into the battery, or immerse or expose it to water or other liquids. Batteries may explode if damaged.
- Use only the battery pack supplied with the product or the same type, sold by the manufacturer or its authorized distributors. Improper use, or use of unapproved batteries may present a risk of fire, explosion, or other hazards, and may invalidate the warranty.
- If you believe the battery is damaged, remove product from the charger and stop using the product.
- Never use a damaged battery.

### 1.4 Information on disposal of battery and product

Always dispose of your battery and product at the end of their life in an environmentally responsible way and in accordance with your local waste disposal requirements. All cardboard and paper packaging materials should be recycled in accordance with your local council waste regulations.

**Thank you for choosing Babysense Video monitor from Hisense Ltd.**

## 2 Overview

### 2.1 Pack Contents

- Parent Unit x 1
- Baby Unit x 1 (x 2 in model V35\_2US - Monitor with two cameras)
- Wide angle lens x 1 (x 2 in model V35\_2US - Monitor with two cameras)
- AC Power Adapter x 2 (x 3 in model V35\_2US - Monitor with two cameras)
- Rechargeable Lithium Ion Battery x 1
- Set for wall mounting x 1 (x 2 in model V35\_2US - Monitor with two cameras)
- User Manual x 1

### 2.2 Parent Unit Overview

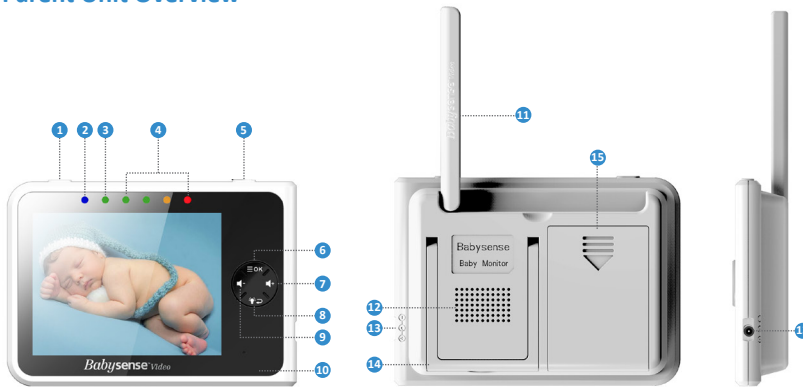

1. Power ON/OFF / SLEEP Button
2. Charging LED
3. Power LED
4. Volume level LEDs
5. TALK & ZOOM IN/OUT Button
6. MENU/OK Button
7. VOLUME UP Button

8. EXIT / NIGHT LIGHT Button
9. VOLUME DOWN Button
10. Microphone
11. Antenna
12. Speaker
13. DC Jack
14. Stand
15. Battery Compartment

## 2.3 Baby Unit Overview

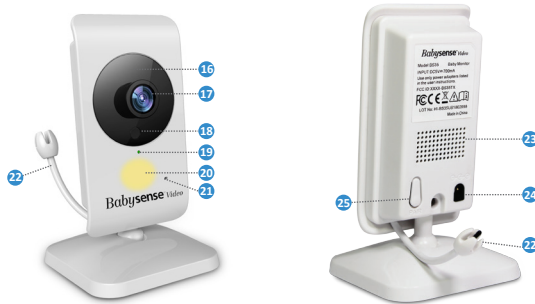

- |                                 |                        |
|---------------------------------|------------------------|
| 16. Infrared LEDs               | 21. Microphone         |
| 17. Wide Angle Lens             | 22. Temperature Sensor |
| 18. Light sensor (Night Vision) | 23. Speaker            |
| 19. Power LED                   | 24. DC Jack            |
| 20. Night Light                 | 25. PAIR Button        |

## 2.4 Icons Overview

	----- Signal		----- Volume
	----- Night Light		----- Brightness
	----- Lullaby		----- ECO
	----- Camera		----- Battery
	----- Zoom	78°F	----- Temperature
	----- Talk to baby		----- Night vision

## 3 Getting Started

### 3.1 Powering The Baby Unit (Camera)

- Connect the Camera Power Adapter to the DC-Jack **(24)** on the back of the Baby Unit.
- Plug the AC power adapter into the wall outlet.
- The unit will power on automatically and the green power LED **(19)** will light up.
- Unplug the Baby Unit to turn it off.

**NOTE:** Only use the AC power adapter included in this package.

### 3.2 Powering The Parent Unit

Connect the Parent Unit Power Adapter to the DC-jack **(13)** on the right side of the Parent Unit.

- Plug the AC power adapter into the wall outlet.
- Press and hold the Power button **(1)** on the top left side of the Parent Unit for 2 seconds to turn the unit on.
- Once the Parent Unit is turned on, the green power LED **(3)** will light up and “Babysense Video” logo will display on the LCD.
- Press and hold the power key **(1)** on the top left side of the Parent Unit for 5 seconds to turn the unit off.

**NOTE:** Only use the AC power adapter included in this package.

**NOTE:** The parent unit is supplied with a built-in rechargeable Li-ion battery (3.7V 1200mAh). Whenever possible, keep the Parent Unit plugged in to keep the battery charged.

### 3.3 Charging The Parent Unit

- Connect the power adapter to the DC-jack **(13)** on the right side of the Parent Unit;
- Plug the AC power adapter into the wall outlet.
- Charging LED **(2)** on the Parent Unit will light up in RED to indicate charging.
- When the unit is turned on, the battery charging icon (changing bars) will appear at the top right corner of the LCD screen.
- Full battery indicator (4 fixed bars) will appear at the top right corner of the LCD screen, indicating the battery is fully charged. The charging LED **(2)** will turn green once the battery is fully charged.

**NOTE:** Before the first use or after a long product storage, it is recommended to fully charge the Parent Unit battery prior to operating the monitor. **It takes approximately 8 hours to fully charge the battery.**

**NOTE:** The monitor can be operated normally during the charging process.

**NOTE:** Low Battery Warning- The battery icon turns red on the LCD screen to indicate that the battery is low. The warning is accompanied with an acoustic beep sound, indicating that the battery needs to be recharged.

### 3.4 Set Up

- Once both the Baby and Parent Units are switched on, the display on the Parent Unit will show the video captured by the Baby Unit.
- The Baby Unit is paired to the Parent Unit when supplied. There is no need to pair the units again unless the Baby Unit loses its link with the Parent Unit. To renew the pairing of your units or pair a new/ additional Baby Unit, follow the procedure described in Section 4.1 on page 9.
- The Baby Unit should be placed at least 6 feet away from the baby's crib on a flat surface. Alternatively, it can be wall-mounted.



- Never place the Baby Unit inside the crib, bed or playpen.
- **Make sure the unit, cords and mains adaptor are out of reach of the baby and other young children.**
- **To avoid a strangulation hazard, the power cords should be secured and never be hung on the crib or near the baby.**
- Place the baby monitor in a place where the air can circulate freely and avoid blocking the ventilation and speaker openings.
- Aim the camera(s) to best optimize the viewing area: Select a location for the camera that provides a clear view of the area you want to monitor, which is free from dust, and is not in line-of-sight to a strong light source or direct sunlight. Avoid installing the camera where there are thick walls or obstructions between the camera and the monitor.
- To use your parent unit and baby unit together, you must be able to establish a radio link between them; the range may be affected by environmental conditions/obstacles (See more details in Troubleshooting Section on page 13- “Interference or poor reception”)

## 4 Operating the Monitor

### 4.1 Pairing the Baby Unit (Camera) with the Parent Unit

The Baby Unit is paired to the Parent Unit when supplied. There is no need to pair the units again unless the Baby Unit loses its link with the Parent Unit. To renew the pairing of your units or pair a new/additional Baby Unit, follow the procedure below:

**NOTE:** Before you begin pairing, be sure to have the Baby and Parent Units side by side and turned on.

- Press the **MENU/OK** button **(6)** on your Parent Unit and the menu screen will pop up.
- Press the **LEFT** button **(9)** or **RIGHT** button **(7)** until the **PAIR** icon is highlighted in red.
- Then press the **MENU/OK** button **(6)** and a secondary menu with camera options will pop up.
- Press the **LEFT** button **(9)** or **RIGHT** button **(7)** to select the desired Baby Unit to pair and press the **MENU/OK** button **(6)** button to start searching for a Baby Unit to pair.
- The chosen Baby Unit will start blinking. Press and hold the **PAIR** button **(25)** in the back of Baby Unit until the connection is established.
- Once paired, an image from the paired Baby Unit will display on the screen.
- Press the **EXIT** button **(8)** to exit the menu.
- If unsuccessful, please repeat above steps.

**NOTE:** If there is more than one Baby Unit to be paired, repeat the above steps for each one individually.

### 4.2 Switching between the paired Baby Units (Cameras)

**NOTE:** This function is only available when two or more cameras are paired.

- To switch between the paired cameras, press the **MENU/OK** button **(6)** on your Parent Unit and the menu screen will pop up.
- Press the **LEFT** button **(9)** or **RIGHT** button **(7)** until the **CAM** icon is highlighted in red.
- Then press the **MENU/OK** button **(6)** and a secondary menu with camera options will pop up.
- Press the **LEFT** button **(9)** or **RIGHT** button **(7)** to select the desired Baby Unit you want to connect to and press the **MENU/OK** button **(6)** button to confirm.
- Image from the selected Baby Unit will display on the screen.
- On the top of the LCD display you will see the number of the Baby Unit it is connected to.
- Press the **EXIT** button **(8)** to exit the menu.

### 4.3 Scan Mode - Automatic switching between the paired Baby Units (Cameras)

You can set the **SCAN** (loop) mode and each paired Baby Unit will be displayed on the screen for 10 seconds and then the screen will automatically change to the next paired Baby Unit.

- Press the **MENU/OK** button **(6)** on your Parent Unit and the menu screen will pop up.
- Press the **LEFT** button **(9)** or **RIGHT** button **(7)** until the **CAM** icon is highlighted in red.
- Then press the **MENU/OK** button **(6)** and a secondary menu with camera options will pop up.
- Press the **LEFT** button **(9)** or **RIGHT** button **(7)** until the Camera Loop icon (last option) is highlighted in red and press the **MENU/OK** button **(6)** button to confirm.
- Now the **SCAN** mode is activated and the monitor will automatically switch between the paired Baby Units with an interval of 10 seconds.
- On the top of the LCD display you will see the Loop icon.
- Press the **EXIT** button **(8)** to exit the menu.
- To deactivate this mode, follow the steps explained in section 4.2 and select any of the paired Baby Units you want to connect to.

### 4.4 Deleting the Baby Unit (Camera)

Press the **MENU/OK** button **(6)** on your Parent Unit and the menu screen will pop up.

- Press the **LEFT** button **(9)** or **RIGHT** button **(7)** until the **PAIR** icon is highlighted in red.
- Then press the **MENU/OK** button **(6)** and a secondary menu with camera options will pop up.
- Press the **LEFT** button **(9)** or **RIGHT** button **(7)** to select the desired Baby Unit to delete and press the **MENU/OK** button **(6)** button.
- The chosen Baby Unit will start blinking. Press and hold the **PAIR** button **(25)** in the back of a Baby Unit you want to keep.
- The above procedure will automatically remove the Baby Unit you want to delete.  
The Baby Unit you want to keep will overwrite the position of the Baby Unit you deleted.
- Press the **EXIT** button **(8)** to exit the menu.

### 4.5 ECO Mode

When using the **ECO** function, the sound and video transmission will stop (standby mode) if the Baby Unit does not register any sound within 30 seconds.

While in standby mode, the LCD screen turns off. Once the Baby Unit registers a sound, louder than the set sensitivity level, it will automatically start transmitting the signal (sound and video) to the Parent Unit and the LCD screen will turn on.

**NOTE:** ECO default setting is OFF in the supplied product.

To change the ECO level, please follow the following instructions:

- Press the **MENU/OK** button **(6)** on your Parent Unit and the menu screen will pop up.
- Press the **LEFT** button **(9)** or **RIGHT** button **(7)** until the **ECO** icon is highlighted in red.
- Then press the **MENU/OK** button **(6)** and a secondary menu with camera options will pop up.
- Press the **LEFT** button **(9)** or **RIGHT** button **(7)** to select the desired sensitivity level (**LOW/MED/HIGH**) and press the **MENU/OK** button **(6)** to confirm.
- On the top of the LCD display you will see the ECO icon.
- Press the **EXIT** button **(8)** to exit the menu.

**NOTE:** ECO-LOW- Low sensitivity level- higher sound level is required to reactivate the transmission  
ECO-MED- Medium sensitivity level- medium sound level is required to reactivate the transmission  
ECO-HIGH- High sensitivity level- low sound level is required to reactivate the transmission  
X – ECO OFF- Constant transmission – no standby mode.

**NOTE:** To resume the video and audio signal manually on your parent unit when ECO function is on, briefly press the **POWER** button **(1)**.

#### 4.6 Audio Only Mode (Video OFF – Audio ON)

• Briefly press the Power button **(1)** to turn the LCD screen ON or OFF.

**NOTE:** This mode will turn the video transmission off but still allow you to hear sounds from the camera/s.

• Press the **POWER** key again to resume the video transmission.

#### 4.7 Talk To Baby

• Press and hold the **TALK** button **(5)** on your Parent Unit to talk to your baby or partner in the baby's room via Baby Unit.

• A microphone icon will be displayed on the bottom of the LCD screen while this function is in use.

• Release the button when you are finished talking.

**NOTE:** While the “Talk To Baby” function is in use, there is no possibility to hear the sounds from the Baby Unit. Releasing the **TALK** button **(5)** allows one to hear the sounds from the baby's room again.

#### 4.8 Digital Zoom & Image Pan/Tilt

Briefly press the **Zoom In/Out** button **(5)** to operate Zoom in/out.

• Once Zoom Mode is activated, Up/Down/Left/Right arrows will pop up on the screen.

• Press the navigation buttons (**LEFT** button **(9)**, **RIGHT** button **(7)**, **MENU/OK** button **(6)** or **EXIT** button **(8)**) to Pan/Tilt the image.

• During Digital Zoom mode, the zoom icon will be displayed on top of the LCD screen.

**NOTE:** To adjust **Volume** or use the **MENU** functions, first exit the Zoom mode before operating it.

#### 4.9 Volume Adjustments

• Press the **RIGHT** button **(7)** to increase the volume.

• Press the **LEFT** button **(9)** decrease the volume.

**NOTE:** In normal use, it is recommended to set the volume at level 3 and below. Higher volume levels are intended for loud/noisy environments.

**NOTE:** If the volume on the Parent Unit is set too high and the Baby and Parent Units are close to each other, a high-pitched ear piercing noise may be heard (also known as feedback or static noise).

## 4.10 Brightness Adjustments

- Press the **MENU/OK** button (6) on your Parent Unit and the menu screen will pop up.
- Press the **LEFT** button (9) or **RIGHT** button (7) until the Brightness icon is highlighted in red.
- Then press the **MENU/OK** button (6) and a secondary menu with brightness level options will pop up.
- Press the **LEFT** button (9) or **RIGHT** button (7) to select the desired brightness level (5 levels) and press the **MENU/OK** button (6) to confirm.
- Press the **EXIT** button (8) to exit the menu.

## 4.11 Temperature Setting

The temperature reading from the temperature sensor (22) at the back of the Baby Unit will be displayed on the top of the screen. To switch between °F (Fahrenheit) and °C (Celsius) follow the below instructions:

- Press the **MENU/OK** button (6) on your Parent Unit and the menu screen will pop up.
- Press the **LEFT** button (9) or **RIGHT** button (7) until the Temperature icon is highlighted in red.
- Then press the **MENU/OK** button (6) and a secondary menu with brightness level options will pop up.
- Press the **LEFT** button (9) or **RIGHT** button (7) to select the desired temperature scale (°F or °C) and press the **MENU/OK** button (6) to confirm.
- Press the **EXIT** button (8) to exit the menu.

**NOTE:** The temperature default setting is °F (Fahrenheit).

**NOTE:** The monitor features a built-in automatic temperature alarm. The monitor will alert (visual indication) when the temperature in baby's room is too high (90°F and higher) or too low (55°F and lower). This feature cannot be adjusted.

**NOTE:** Make sure the temperature sensor is not positioned too close to the camera body as it may affect the correct temperature reading. It is recommended to stretch out the sensor so it is as far away from the camera body as possible. Also, it is recommended to place the camera in an area where there is good air circulation and not in a closed cornered area where the temperature tends to be higher.

## 4.12 Lullaby & White Noise Setting

You can soothe the baby to sleep by playing 4 pre-programmed lullabies from the Baby Unit. The monitor also features a White Noise sound, which is an effective way to soothe a crying infant and lull your newborn to sleep. Lullaby and White Noise feature is controlled remotely from the Parent Unit.

- Press the **MENU/OK** button (6) on your Parent Unit and the menu screen will pop up.
- Press the **LEFT** button (9) or **RIGHT** button (7) until the Lullaby icon is highlighted in red.
- Then press the **MENU/OK** button (6) and a secondary menu with brightness level options will pop up.
- Press the **LEFT** button (9) or **RIGHT** button (7) to select the desired melody (1-4), a **LOOP** mode or a **White Noise** sound. Press the **MENU/OK** button (6) to confirm.
- Press the **EXIT** button (8) to exit the menu.
- In order to stop the lullaby playback, go to the "Lullaby Setting" menu and select OFF icon.

**NOTE:** Once the lullaby function is turned on, the lullaby icon will be displayed on top of the LCD screen.

**NOTE:** The lullaby default setting is OFF.

**NOTE:** When playing the lullabies in a loop mode only the 4 melodies are available; the White Noise does not play in the loop mode.

### 4.13 Warning Alert Setting

This setting controls the volume of an audio “beep” sound alerting when the Parent Unit is low on battery or out of range (no connection to Baby Unit). You can set a lower volume level during the night and higher level during the day.

- Press the **MENU/OK** button (6) on your Parent Unit and the menu screen will pop up.
- Press the **LEFT** button (9) or **RIGHT** button (7) until the **ALERT** icon is highlighted in red.
- Then press the **MENU/OK** button (6) and a secondary menu with brightness level options will pop up.
- Press the **LEFT** button (9) or **RIGHT** button (7) to select the desired alert volume: **MUTE, LOW, MED or HIGH**. Press the **MENU/OK** button (6) to confirm.
- Press the **EXIT** button (8) to exit the menu.

**NOTE:** Selecting **MUTE** option will turn all alerts OFF. In case of low battery or out of range, there will be no acoustic notification heard.

### 4.14 Night Light

This monitor features a night light integrated into the Baby Unit (20), allowing you to remotely activate a comforting glow to baby’s room.

- Press the **EXIT** button (8) to activate the Night Light on the Baby Unit.
- Press the **EXIT** button (8) again to deactivate it.

**NOTE:** The Night Light status icon (ON or OFF) will be displayed on top of the LCD screen.

**NOTE:** Night Light feature can also be activated manually on the Baby Unit. Briefly press the **PAIR** button (25) in the back of the Baby Unit. Press again to deactivate.

## 5 Using the Wide Angle Lens

The supplied Wide Angle Lens provides better control over the viewing angle. It captures a wider viewing area, allowing you to see more around the Baby Unit. Best for active babies and toddlers. To use the lens, just screw it onto the Baby Unit as illustrated below:



Normal View – Baby Unit with no Lens



Wide Angle View – Baby Unit with the Lens



Screw the lens onto the Baby Unit

**NOTE:** Always ensure the lens is screwed tightly onto the Baby Unit.

## 6 Maintenance

- All of the following maintenance procedures should only be performed when Baby and Parent Units are unplugged.
- Clean the surfaces of the Baby and Parent Units with a soft, fluff-free cloth.
- Never use cleaning agents or solvents.
- If the units become dirty, use a lightly damp cloth to wipe surfaces, taking care not to allow water into any openings.
- Wide Angle Lens cleaning – smudges and dust on the lens can diminish sharpness and reduce video quality. Clean the lens surface by using a microfiber cloth or a piece of lens tissue. Wipe the lens in a circular motion.

## 7 Troubleshooting

<b>Problem</b>	<b>Possible cause/solution</b>
<b>No reception on the Parent Unit</b>	<ul style="list-style-type: none"><li>• The power adapters may not be properly connected.</li><li>• Ensure that the Baby and Parent Units are ON.</li><li>• Adjust the monitor antenna to vertical position.</li><li>• Make sure the Baby and Parent Units are not far away from each other.</li><li>• Baby and Parent Units may not be properly paired. Follow PAIRING instructions on page 9.</li></ul>
<b>Interference or poor reception</b>	<ul style="list-style-type: none"><li>• Move the Baby unit closer to Parent unit.</li><li>• Use of other 2.4GHz products, such as wireless networks (Wi-Fi routers), Bluetooth systems, or microwave ovens, may cause interference with this product, so keep the baby monitor at least 5ft (1.5m) away from these types of products, or turn them off if they appear to be causing interference.</li><li>• The Baby or Parent units may be too close to metal objects.</li><li>• Other electronic devices may be interfering with the signal.</li><li>• The battery power may be too low.</li></ul>
<b>Image frozen on the Parent Unit</b>	<ul style="list-style-type: none"><li>• Restart the Baby Unit (unplug the power adapter from the wall outlet, wait for approx. 5 seconds and plug it back into the wall outlet).</li><li>• Reset the Parent unit by disconnecting (for 5 seconds) and reconnecting the battery pack.</li></ul>
<b>A high pitched ear piercing noise is heard from the units (feedback, static)</b>	<ul style="list-style-type: none"><li>• The Baby Unit and Parent Unit may be too close to each other. Move them further apart.</li><li>• The volume on the Parent Unit may be set too high. Lower volume.</li></ul>
<b>Cannot hear the baby sounds on the Parent Unit</b>	<ul style="list-style-type: none"><li>• Volume setting on the Parent Unit may be too low. Increase the volume.</li><li>• Battery power may be too low. Recharge the battery.</li></ul>

<b>Background noises</b>	<ul style="list-style-type: none"> <li>• In a quiet environment, surrounding the Parent Unit, decrease the volume on your Parent Unit to level 3 and below.</li> <li>• In a loud environment, surrounding the Parent Unit, increase the volume to the maximum level.</li> </ul>
<b>Picture is black and white</b>	<ul style="list-style-type: none"> <li>• Automatic Night vision mode may be on. Turn on the room lights to force monitor out of night vision mode.</li> </ul>
<b>Lines/marks across the screen</b>	<ul style="list-style-type: none"> <li>• Lens is dirty. Follow the Maintenance procedure on page 16.</li> <li>• Confirm that power adapters are properly connected.</li> <li>• Restart the Baby Unit ( unplug the power adapter from the wall outlet, wait for approx. 5 seconds and plug it back into the wall outlet).</li> <li>• Reset the Parent unit by disconnecting (for 5 seconds) and reconnecting the battery pack.</li> </ul>
<b>The rechargeable battery will not charge or no charge light shows</b>	<ul style="list-style-type: none"> <li>• The power adapter may not be properly connected.</li> <li>• Battery pack may not be properly connected inside the battery compartment. Disconnect and reconnect the battery pack.</li> <li>• Switch to another wall outlet.</li> </ul>

**IMPORTANT: If the above troubleshooting guide did not help you solve your problem, please contact our customer service via:**

**Email - [service@hisense.co.il](mailto:service@hisense.co.il)**  
**Toll Free Number – (833) 568-2229**  
**Website - [www.babysensellc.com](http://www.babysensellc.com) (Refer to FAQ Section)**

## 8 Specifications

Product Model	V35RX
Frequency	2.4GHz
Type of Modulation	GFSK
Data Rate	3 Mbps
Channel Bandwidth	3.752 MHz
Transmission Range	Up to 960 feet / 300 meters (open space – no obstructions)
Input Voltage	5V, 700mA
Power Adapter	Input: 240-100VAC 60 / 50Hz, 200mA Max; Output: 5V, 700mA;
LCD Screen	3.5" TFT LCD
Rechargeable battery (built-in in Parent Unit) Operating time with battery fully charged (Parent Unit) * It takes about 8 hours to fully charge the battery.	Model: YS603450 3.7V, 1200 mAh
Transmitting Power	19.38dBm
Image sensor type	6.5/1 " Color CMOS
IR LED Type	940nm
Operation Environment	Indoor use only; Temperature: °104-32F / °40-0C Humidity: %5 to %90 rh. (relative humidity)

## 9 FCC Statements

This device complies with part 15 of the FCC Rules. Operation is subject to the following two conditions:

- (1) This device may not cause harmful interference.
- (2) This device must accept any interference received, including interference that may cause undesired operation.

**NOTE 1:** This equipment has been tested and found to comply with the limits for a Class B digital device, pursuant to part 15 of the FCC Rules. These limits are designed to provide reasonable protection against harmful interference in a residential installation.

This equipment generates, uses and can radiate radio frequency energy and, if not installed and used in accordance with the instructions, may cause harmful interference to radio communications. However, there is no guarantee that interference will not occur in a particular installation. If this equipment does cause harmful interference to radio or television reception, which can be determined by turning the equipment off and on, the user is encouraged to try to correct the interference by one or more of the following measures:

- Reorient or relocate the receiving antenna.
- Increase the separation between the equipment and receiver.
- Connect the equipment into an outlet on a circuit different from that to which the receiver is connected.
- Consult the dealer or an experienced radio/TV technician for help.

**NOTE 2:** Any changes or modifications to this unit not expressly approved by the party responsible for compliance could void the user's authority to operate the equipment.



## 10 IC Statements

This device complies with Industry Canada license-exempt RSS standard(s):

Operation is subject to the following Two conditions:

- (1) this device may not cause interference, and
- (2) this device must accept any interference, including interference that may cause undesired operation of the device.

Le présent appareil est conforme aux CNR d'Industrie Canada applicables aux appareils radio exempts de licence.

L'exploitation est autorisée aux deux conditions suivantes:

- (1) l'appareil ne doit pas produire de brouillage, et
- (2) l'utilisateur de l'appareil doit accepter tout brouillage radioélectrique subi, même si le brouillage est susceptible d'en compromettre le fonctionnement.

## 11 Warranty Terms

We take quality very seriously. This is why all of our products come with a one year warranty from the original purchase date against defects in workmanship and materials. If you have warranty or support issues please contact our customer service: [service@hisense.co.il](mailto:service@hisense.co.il)

## 12 Customer Support

If you have any problems setting up or using this product, you will find useful tips and information in the Troubleshooting section of this user guide.

If you have any further questions about using the product after reviewing the resources above or would like to purchase replacement parts or accessories, please contact us via:

**Email - [service@hisense.co.il](mailto:service@hisense.co.il)**  
**Toll Free Number – (833) 568-2229**  
**Website - [www.babysensellc.com](http://www.babysensellc.com)**

### **RF Exposure:**

To maintain compliance with FCC's RF Exposure guidelines, This equipment should be installed and operated with minimum distance between 20cm the radiator your body: Use only the supplied antenna.

*Video Baby Monitor*  
*By Babysense™*